

**STONEBIRCH SERIES**

**SINGLE SECTION**

**STANDARD FEATURES**

**CONSTRUCTION**

12" Steel I-Beam Chassis  
Full Length Outriggers  
2 x 4 Exterior Walls 16" o.c.  
2 x 6 Floor Joist 16" o.c.  
Drywall Construction  
Truss Type Rafters  
Zone One Insulation  
Vaulted Ceiling Throughout  
Sprayed Acoustic Ceilings  
5/8" Subfloor

**INTERIOR**

Valances Throughout  
Mini Blinds Throughout  
Brushed Nickel Door Knobs Throughout  
Wrapped Molding  
Wrapped Door Jambs  
30" Bedroom Doors

**EXTERIOR**

Mini Gutters Along Roof  
Starter Metal – Entire Home  
Mill Finished Windows  
Exterior Light at Each Ext Door  
House Type Front Door W/Storm

**KITCHEN**

Deep Stainless Steel Dbl Bowl Sink  
Decorative Molding on Kitchen Cabinets  
Center Shelves in all O/H Cabinets  
Base Shelf in all Cabinets  
White Lined Cabinets  
Metal Roller Guides  
Recessed Toe Kick  
Pantry in Kitchen (Most Models)  
Electric Range  
42" Recessed Range Hood  
Whirlpool Appliances  
Raised Panel Cabinet Doors  
Recessed Hinges on Cabinet Doors  
Brushed Nickel Cabinet Pulls  
30" Overhead Cabinets

**ELECTRICAL/PLUMBING**

200 Amp Service  
Smoke Detectors  
100% Cooper Wiring  
GFI Protected Receptacles in all Baths  
GFI Protected Receptacles at Kit Sink  
GFI Protected Exterior Receptacle  
Exhaust Fan in all Baths  
Electric Furnace – A/C Ready  
30 Gallon Water Heater  
ABS Drain Lines  
Vanguard Ultra Pex Plumbing System

**BATH**

Glamour Bath (Most Models)  
Dressing Table in Master Bath  
Framed Mirror in all Baths (Most Models)

**POPULAR OPTIONS**

Thermal Zone II or III  
Ceiling Fan  
Wainscot in Living Room  
Microwave Oven

Upgrade Carpet  
Fireplace  
Dishwasher  
Storm Windows

Steel Front Doors  
Cut-Off Valves  
Plywood Floors  
Backsplash in Kitchen

**Model 1013 76 x 16 3 Bedrooms 2 Baths 1080 Sq. Ft.**

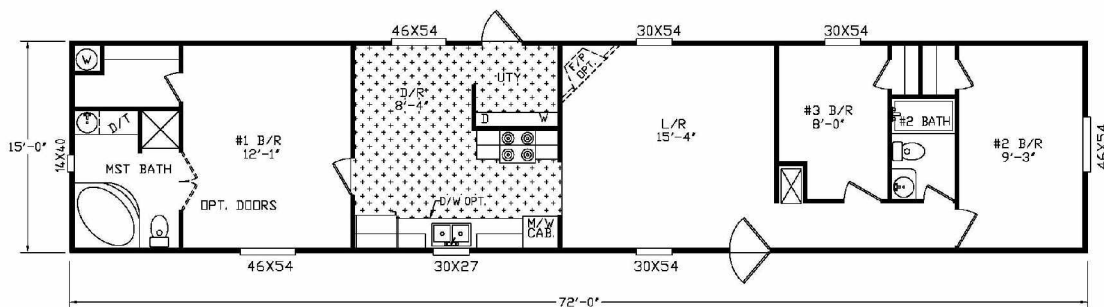

1013